

PANEL BLINDS FITTING INSTRUCTIONS

FITTING COMPONENTS



Face Fixing Bracket:
If ordered



Top Fixing Bracket



Connecting bracket:
If over 2500mm

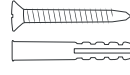

Screws
Rawl plugs

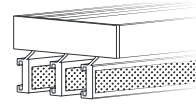

Headrail

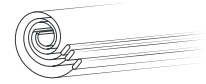

Panels

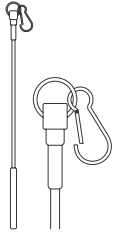

Wand/s

FITTING HARDWARE



Drill



Philips head
screwdriver



Stepladder



Drill bit



Pencil

1

FIXING THE BRACKETS

- **Face Fixing:** If you require face-fixing a face fix bracket extender will be needed. This will be provided with your blind if this option was selected at purchase. Secure the top fix brackets to the face fit bracket extender, ensuring each bracket is secured using the correct fittings. Then screw a face fixing bracket extender onto the facing surface, one for each end of the blind width. Then follow the process detailed below.

Face Fixing

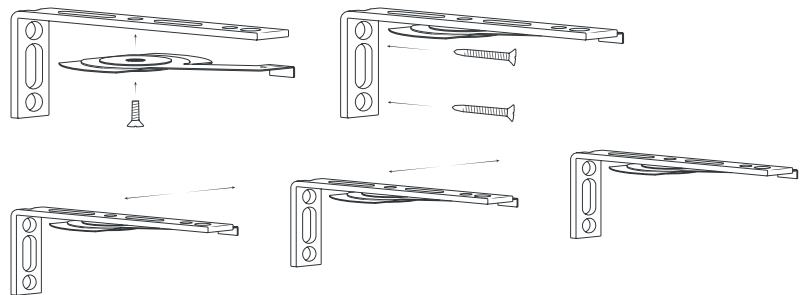

- **Top Fixing:** Evenly space brackets along the length of the panel track to which you will attach your blind. Ensure each bracket is secured to the wall with just one screw fixing. The required amount of brackets will be provided in relation to the width of the blind purchased.

Top Fixing

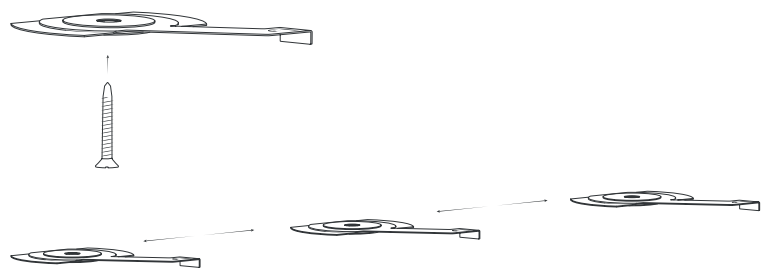

2

FIXING THE EXTENDER

If your width is greater than 2500mm, 2 tracks and a joining plate to connect them together will be provided. Slot the joining plate into the channel at the top of one part of the rail, then slot the other part of the rail into place beside it, ensuring this is central to the joining plate. Next, insert the screws provided into the fixing plate holes and screw tightly, securing the rails together.

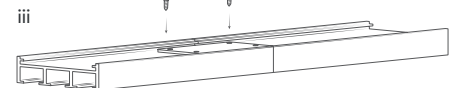
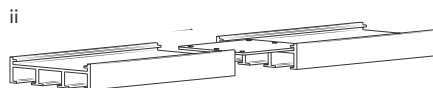

3

MOUNTING THE BLIND

Place the rail track into the brackets and secure by rotating the turnbuckle on the brackets.

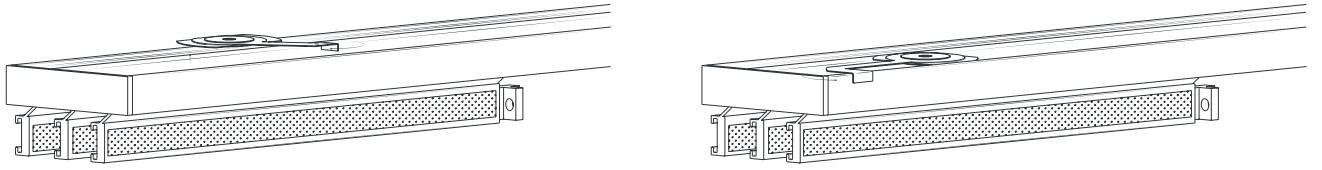

4

FITTING THE PANELS

Secure the panel to the track using the Velcro strip found on the top edge of each panel starting from the blind nearest to the window. Repeat this process one panel at a time, building the blind up from the back forwards.

If you have selected split draw, simply Velcro the panels on from side to side instead of working from the back to the front.

Ensure the panels line up evenly with the bottom bar, adjusting from the top panel Velcro if required.

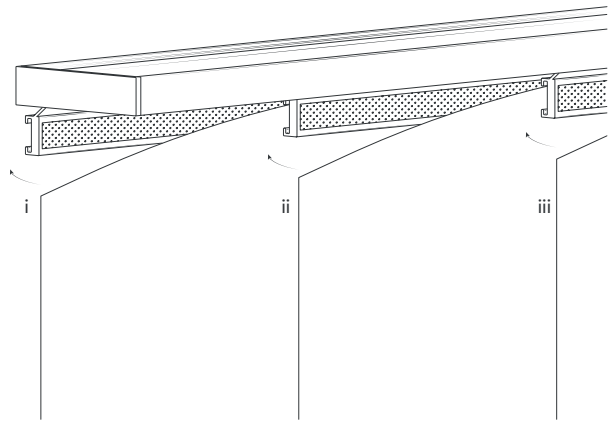

5

ATTACHING THE WAND

Finally, hook the control wand through the eyelet at the end of the frontmost panel glider.

