

wooden venetian blinds

measuring instructions

For accurate measurements please use a metal tape measure, and take measurements in centimetres, to the nearest 0.1cm.

- All of our blinds can be fixed into the face of the window frame or wall, or into the top of the lintel - allowing you total control of the depth your blind can be positioned in the depth of your window recess.
- Choose whether you want the blinds to hang inside or outside the window recess.
- Please check for the proximity of adjacent walls, furniture, window handles etc. when measuring for your blinds.

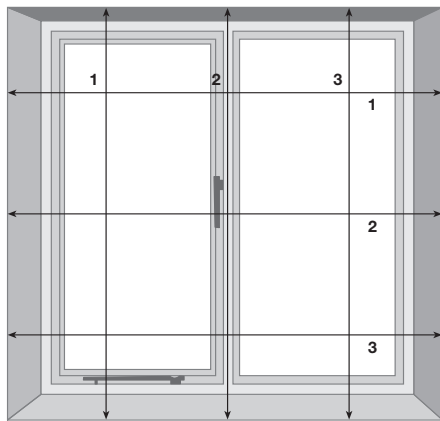

Recess

For blinds to hang inside the window recess:

Measure the drop by taking the measurement from the top of the recess to the window sill, in three places as shown. Measure the width of the window recess from wall to wall, in three places as shown. Take the smallest measurement. We will make all adjustments to ensure your blinds fit perfectly.

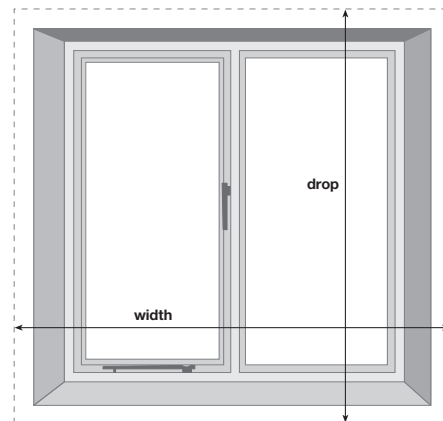

Exact

For blinds to hang outside the window recess:

Measure the exact area you would like the blind to cover as shown.

aftercare

Look after your blinds by following the straightforward operating instructions below.

Operating

- One cord on the Wooden Venetian operates the height of the blind.
- The other cord operates the angle of the slats.
- To raise the blind pull the cord down until the blind reaches your desired height.
- To lower the blind pull the cord across the face of the blind to release the cordlock and let cord slide through your fingers.
- To adjust the angle of the slats pull the other cord until they are at the desired angle.
- When raising or lowering the blind slats should be in the open position.
- **Please note:** Wooden Venetians do not close totally - it is the nature of the product.

Cleaning

- Your Wooden Venetians should only be cleaned with a dry non-lint cloth.

Your local supplier:

NB: The manufacturer will not accept responsibility for damage to blinds caused by misuse.
Fitting items may vary depending upon type of fitting requested.

wooden venetian blinds

fittings

- 1** End brackets (pair)

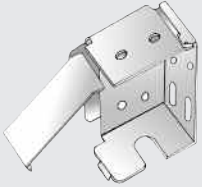

- 2** Matching fascia

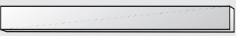

- 3** Matching end returns (if blind is to be fitted outside the window recess).

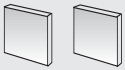

- 4** Centre support bracket (if length requires).

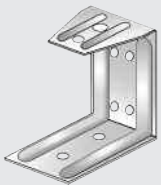

- 5** Screws: min 4

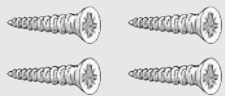

- 6** Rawl plugs: min 4

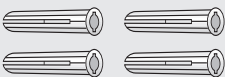

- 7** Blind: 1

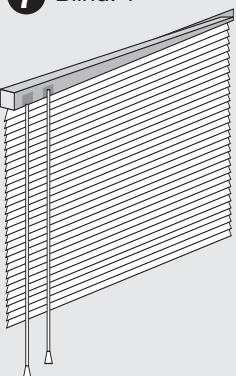

fitting instructions

Outside Recess

If fitting the blind outside the window, measurements **(C)** will need to be the same. To work out **(C)**, simply minus **(B)** from **(A)** and divide the answer by two. Follow instructions for FACE FIXING

Inside recess

Decide whether to FACE or TOP FIX. FACE FIX to fit the bracket to the window frame. TOP FIX to the lintel if the window frame is uPVC, or if there are any obstructions, e.g. window handles.

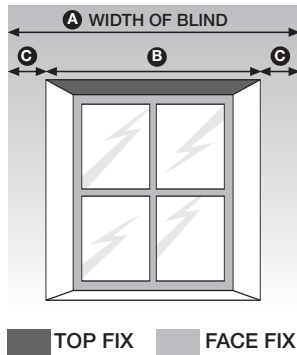

step one

Extend hinged door on each bracket as far as it will go. Identify left and right brackets from light L and R markings inside. Position the bracket and mark two holes according to type of fixing chosen in Step One.

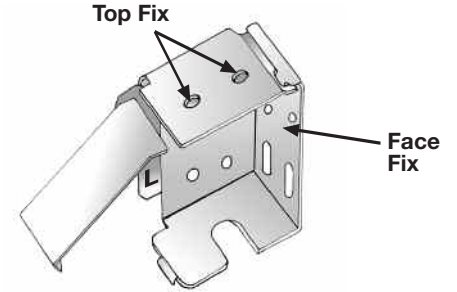

step two

Once the brackets are fitted, remove plastic end caps from blind headrail. Slide the blind into the brackets, with velcro patches facing towards you.



step three

Push down and snap shut the hinge doors to lock the headrail into position.

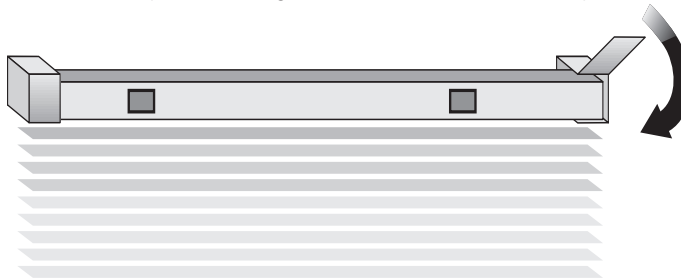

step four

Remove the thin plastic backing from both velcro patches, leaving adhesive surfaces. Position fascia on front and press firmly to adhere. If supplied, wooden returns will fit automatically in place at ends of headrail.

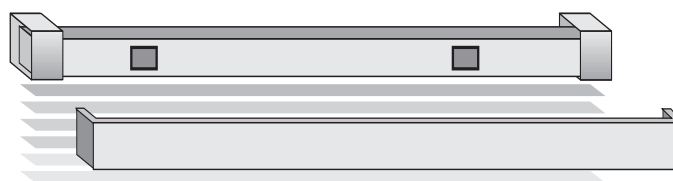

step five

Use one set of cord controls to raise and lower the blind, pulling it to one side to lock into the desired position. Use the other cord controls to angle the louvres.

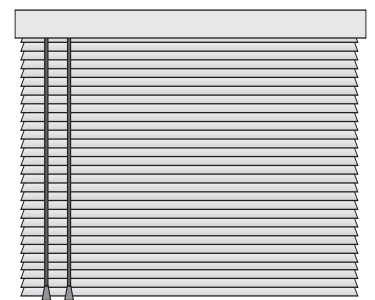

step six

WARNING

IN THE INTEREST OF SAFETY, IT IS ADVISABLE TO KEEP ALL PULL CORDS AND CHAIN/BEAD CORDS OUT OF THE REACH OF CHILDREN.